



BATTERY MONITOR Quick Start Guide



GP-BMK-50

INCLUDES:

1 x Battery monitor

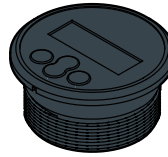

1 x Battery coupling

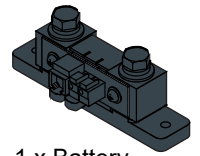
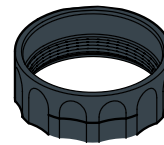

1 x Battery Monitor Connector

1 x Face plate

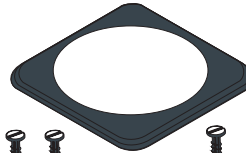

2 x Pos. supply cable



4 x Screws



1 x Mounting plate



1 x UTP cable

1 PLANNING

Plan where the battery monitor will be located in the RV keeping your 50' of cord in mind.

2 INSTALLATION

1. Trace the base of the battery monitor on the wall where it will go (See Figure 2-A)
2. Cut out the circle you have traced, (See figure 2-B)
3. Remove any sharp edges from the hole.
4. In Method 1, place the coupling through the wire and connect the wire to the battery monitor. (See figure 3-A)
5. Screw the coupling onto the back of the monitor. (See figure 3-B)
6. In Method 2, click the mounting plate onto the battery monitor. (See figure 4-A)
7. Place the monitor into the hole that has been cut and trace the four small holes for the screws. (See figure 4-B)
8. Then pull the monitor out and connect the cable before reinserting. (See figure 4-C)
9. Place the connected monitor back into the hole and secure with the four screws before snapping the faceplate on for the final step. (See figure 4-D)

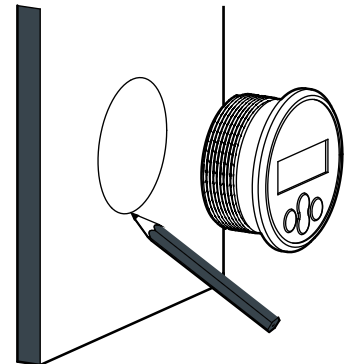

FIGURE 2-A

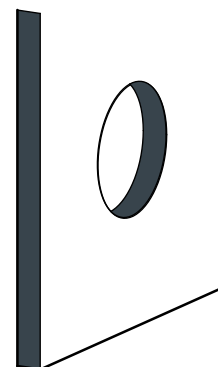

FIGURE 2-B



INSTALLATION METHOD 1

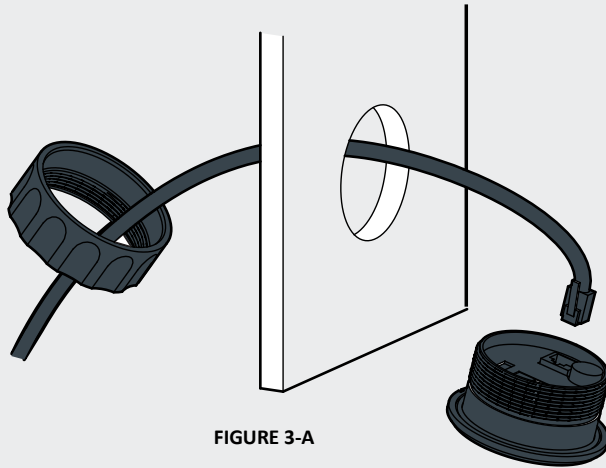

FIGURE 3-A

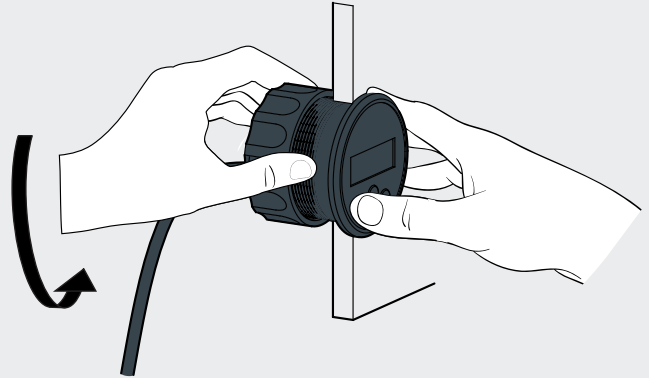

FIGURE 3-B

INSTALLATION METHOD 2

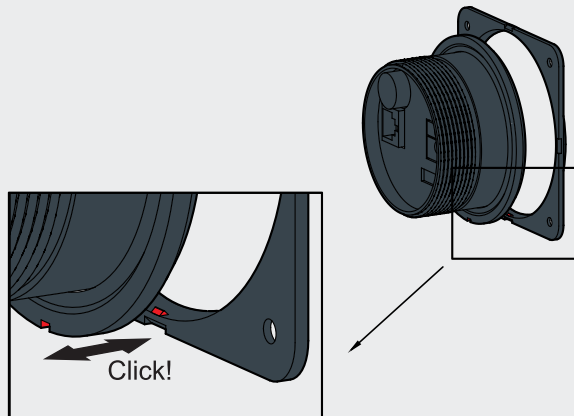

FIGURE 4-A

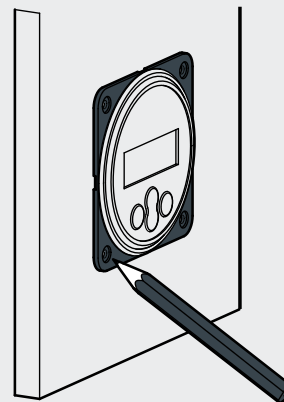

FIGURE 4-B

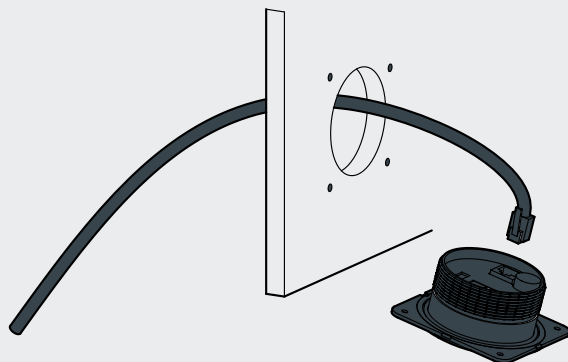

FIGURE 4-C

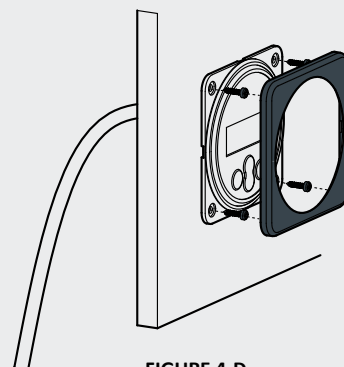
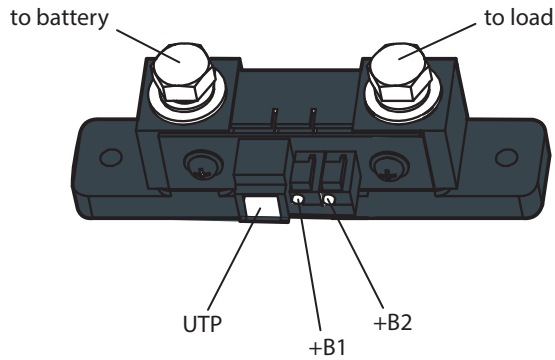

FIGURE 4-D



BATTERY SHUNT CONFIGURATION

Battery Monitor Connector



WARNING - ELECTRIC SHOCK



Connect the negative pole of the battery LAST!

GP-BMK-50 CONFIGURED FOR STARTER/MAIN/AUXILIARY BATTERY MONITORING WIRING DIAGRAM

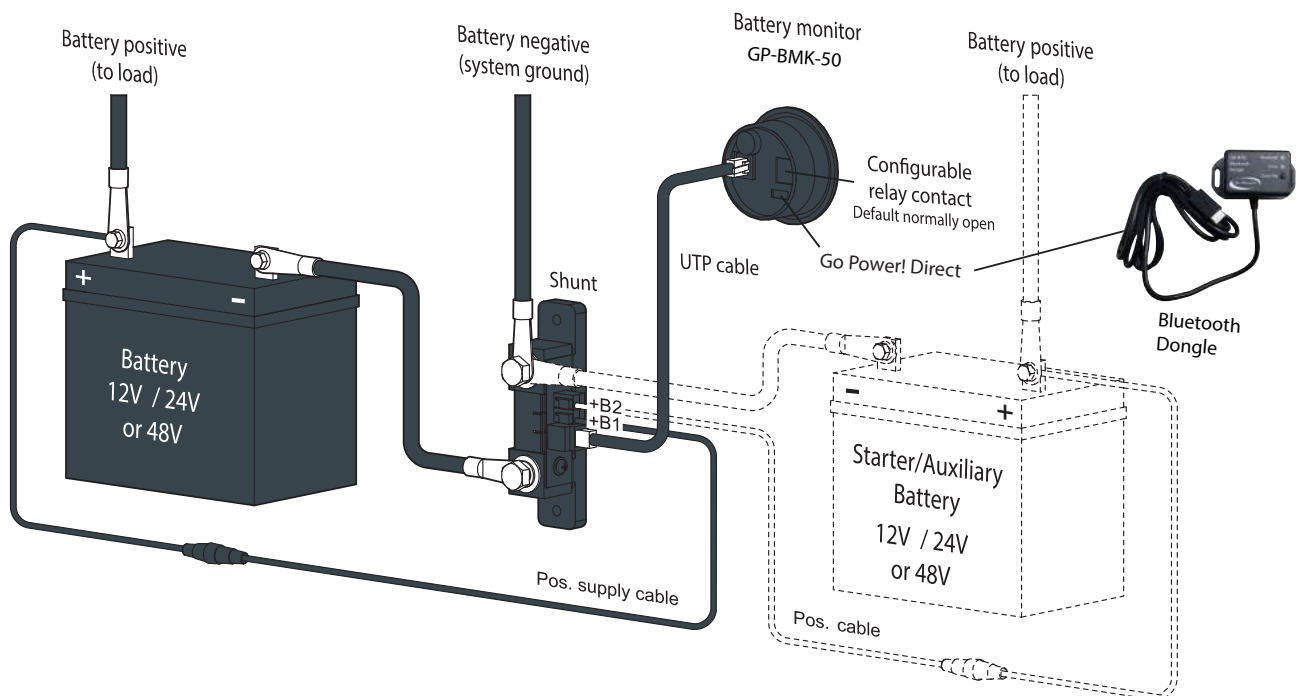



PLEASE NOTE:

In case of Li-Ion batteries, several settings may have to be changed after the setup wizard is completed. Please refer to the manual.

The BMK will automatically adjust itself to the nominal voltage of commonly used battery systems.

Please refer to the manual for more information.

WIRING DIAGRAMS



Connect the negative pole of the battery LAST!

GP-BMK-50 configured for battery TEMPERATURE monitoring

